

DESCRIPTION	REVISIONS	DATE

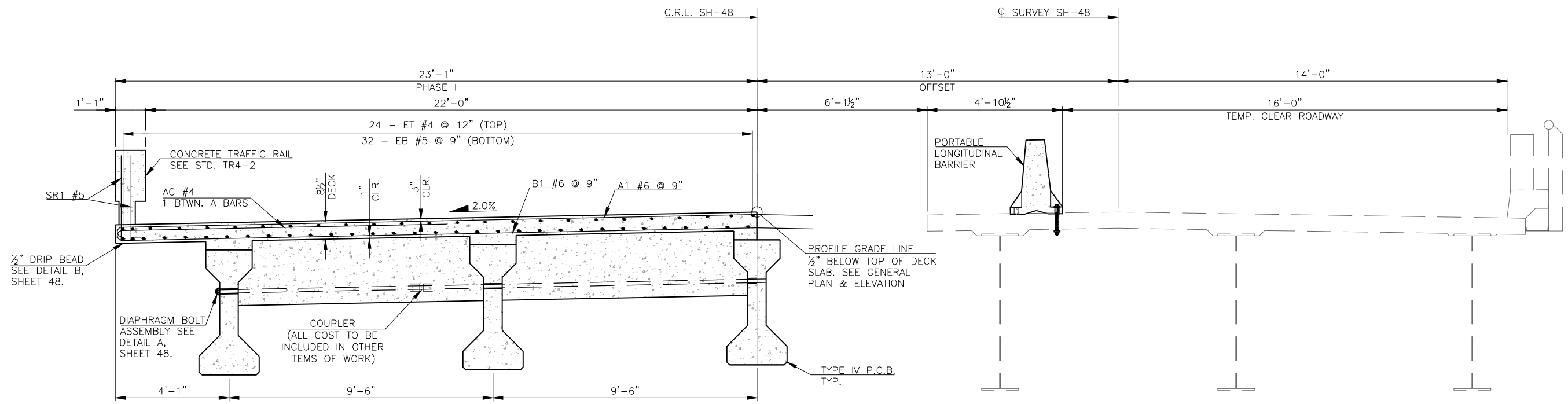

HALF SECTION AT END DIAPHRAGM

TYPICAL CROSS SECTION
PHASE I (SPANS 1-2)

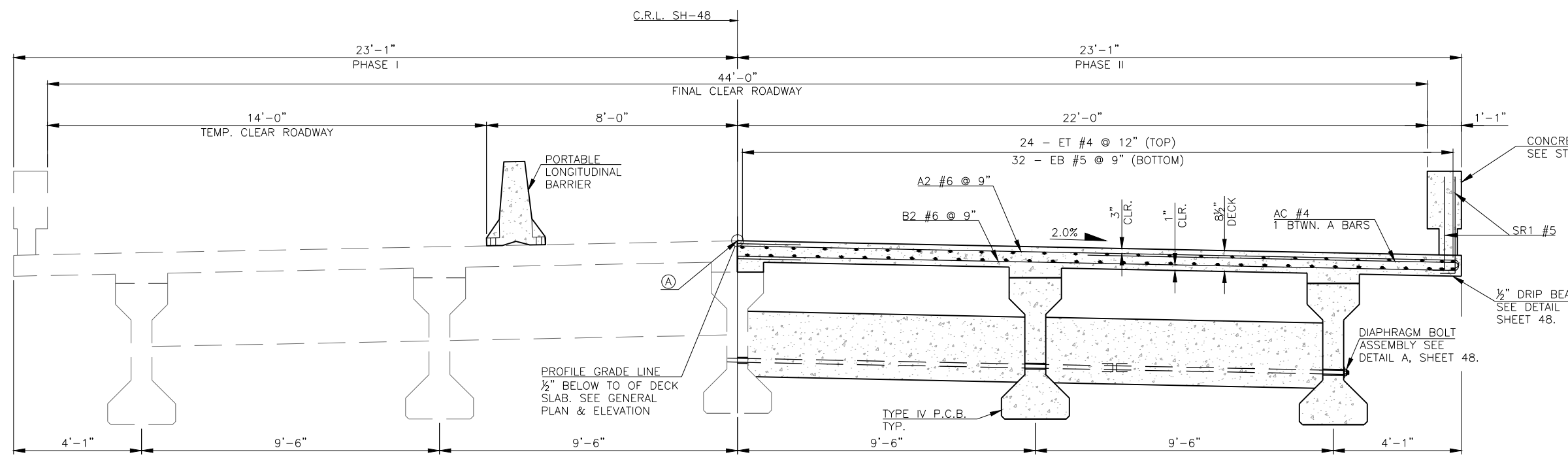

HALF SECTION AT INTERMEDIATE DIAPHRAGM

TYPICAL CROSS SECTION
PHASE II (SPANS 1-2)

- NOTE:
FOR SUPERSTRUCTURE QUANTITIES,
SEE SHEET 49.
- NOTE:
FOR BAR BENDS AND BAR LIST,
SEE SHEET 58.
- NOTE:
ROTATE HOOKS ON A BARS
TO MAINTAIN MINIMUM
CLEARANCE.
- NOTE:
FOR ADDITIONAL PORTABLE
LONGITUDINAL BARRIER DETAILS,
SEE SHEET 28.
- (A) GRIND LONGITUDINAL CONSTRUCTION JOINT TO
PROVIDE A SMOOTH ROUNDED SURFACE AS
APPROVED BY THE ENGINEER. INCLUDE ALL
COSTS FOR GRINDING BRIDGE DECK TO
SMOOTHNESS, INCLUDING LABOR, EQUIPMENT,
AND INCIDENTALS REQUIRED TO COMPLETE THE
WORK IN THE PRICE BID FOR "CLASS AA
CONCRETE". SEAL LONGITUDINAL JOINT WITH
HIGH MOLECULAR WEIGHT METHACRYLATE
AFTER ALL GRINDING HAS BEEN COMPLETED.

DESIGN	B.J.K.	SH-48 OVER CIMARRON RIVER	CREEK COUNTY
DRAWN	B.M.S.	TYPICAL CROSS SECTION (SPAN 1-2)	
CHECKED	M.R.S.		
APPROV.	B.J.K.		
SQUAD	CEC		
		JOB PIECE NO. 27925(04)	SHEET NO. 46